

# LOBO AirGuns

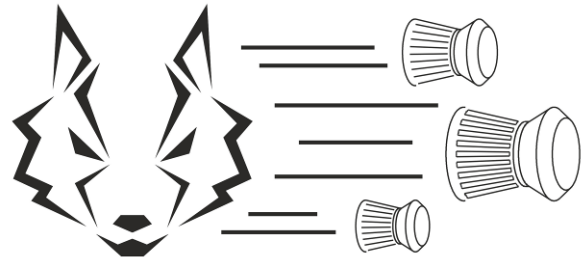

## **XR-100®**

Compressed air carbine

User manual and safety instructions



## **INDEX**

- 1. SAFETY WARNINGS**
- 2. GUARANTEE**
- 3. LOADING AND ARMING THE CARBINE**
- 4. SET BALLASTS**
- 5. REMOVE THE CYLINDER HEAD**
- 6. POWER ADJUSTMENT**
- 7. AIR LOAD**
- 8. ROTATING THE CANYON**
- 9. WITHDRAW THE DEPOSIT**
- 10. SETTING THE TRIGGER**
- 11. SPECIFICATIONS**
- 12. DIAGRAMS AND EXPLODED VIEWS**

## **1. WARNINGS**

### **1.1. LEGISLATION AND SECURITY**

THE PURCHASER AND USER ARE OBLIGATED TO OBEY ALL LAWS PERTAINING TO THE USE AND OWNERSHIP OF THIS WEAPON.

SHOULD NOT DISPLAY THIS CARBINE IN PUBLIC, AS IT COULD BE MISTAKEN FOR A REAL FIREARM.

### **1.2. USAGE**

ALWAYS HANDLE THE CARBINE AS IF IT WERE LOADED AND NEVER LEAVE IT UNATTENDED. NEVER POINT THIS CARBINE AT ANYONE, EVEN IF IT IS UNLOADED, AND NEVER ALLOW ANYONE TO POINT IT AT YOU.

NEVER USE OR HANDLE A CARBINE UNDER THE INFLUENCE OF ALCOHOL, DRUGS OR MEDICATION.

### **1.3. STORAGE**

STORE YOUR UNLOADED CARBINE IN A SAFE PLACE OUT OF THE REACH OF CHILDREN. PREFERABLY UNDER LOCK AND KEY.

STORE AMMUNITION AND CARBINE IN SEPARATE LOCATIONS.

### **1.4. TRANSPORT**

WHEN TRANSPORTING A CARBINE, ALWAYS CARRY IT UNLOADED; THE CARBINE MAY FIRE ACCIDENTALLY IN THE EVENT OF A FALL OR HEAVY BLOW. IF YOUR CARBINE IS EQUIPPED WITH A TRIGGER LOCK, ACTIVATE IT TO PREVENT ACCIDENTS.

### **1.5. BEFORE FIRING**

ALWAYS PROTECT YOUR EYES AND EARS AND THOSE OF BYSTANDERS WITH SHOOTING GLASSES AND HELMETS WHILE USING THIS CARBINE. FAILURE TO DO SO MAY LEAD TO SERIOUS AND IRREVERSIBLE INJURY.

IF YOUR CARBINE HAS A TRIGGER LOCK, MAKE SURE YOU ALWAYS HAVE IT ENGAGED UNTIL YOU ARE READY TO FIRE.

BEFORE FIRING, ASSESS THE RISK OF MISSING THE TARGET. DO NOT SHOOT IF YOU ARE NOT COMPLETELY SURE WHAT IS BEHIND THE TARGET.

BE SURE TO AIM ACCURATELY AT THE TARGET BEFORE FIRING BY ALWAYS KEEPING A SAFE DISTANCE BETWEEN YOU AND THE TARGET WHEN FIRING.

WE RECOMMEND THAT YOU USE A FIRM TARGET AND A LINE SHOOTER.

SELECT SAFE TARGETS. BE AWARE THAT SOME TARGETS MAY DEFLECT OR BOUNCE THE PELLETS, SUCH AS THE SURFACE OF WATER.

### **1.6. HANDLING**

THIS CARBINE MUST ONLY BE LOADED WITH COMPRESSED AIR. OTHER GASES SUCH AS OXYGEN, WHICH COULD CAUSE A FIRE OR EXPLOSION, MAY NOT BE USED.

DO NOT ATTEMPT TO DISASSEMBLE OR TAMPER WITH YOUR CARBINE. THE INTERNAL MECHANISM IS COMPOSED OF PARTS INCLUDING SPRINGS UNDER TENSION AND CYLINDERS WITH COMPRESSED AIR AT HIGH PRESSURES WHICH CAN CAUSE SERIOUS INJURY.

DO NOT MAKE ANY MODIFICATIONS OF ANY KIND TO THIS CARBINE TO MAKE IT RESEMBLE A REAL FIREARM. THIS IS VERY DANGEROUS AND COULD BE A CRIMINAL OFFENCE.

IN NO EVENT SHALL THE MANUFACTURER AND/OR DISTRIBUTOR BE LIABLE FOR ANY IMPROPER USE OR HANDLING OF THIS CARBINE BY THE USER.

THE USER SHALL BE LIABLE FOR ANY DAMAGE THAT MAY RESULT FROM IMPROPER HANDLING OF THIS CARBINE.

## **2. GUARANTEE**

LOBO AIRGUNS PCP CARBINES COME WITH A WARRANTY ON DEFECTIVE PARTS AND LABOUR. THE WARRANTY PERIOD IS 2 YEARS AND IS NOT TRANSFERABLE.

THE WARRANTY ONLY APPLIES TO NEW CARBINES AND PROOF OF PURCHASE IS REQUIRED TO QUALIFY FOR THE WARRANTY.

DAMAGE DUE TO MISUSE, TAMPERING OR MODIFICATION OF THE CARBINE IS EXCLUDED FROM THE WARRANTY AND ALL REPAIRS MUST BE CARRIED OUT BY LOBO AIRGUNS. LOBO AIRGUNS RESERVES THE RIGHT TO WAIVE SHIPPING AND/OR OVERHAUL COSTS.

### 3. LOADING AND ARMING

The XR-100 is a single shot carbine, which means that you have to arm it and insert a pellet for each shot you want to fire. Once you have chosen a pellet of the right caliber, all you have to do is move the loading lever to its most open position until the trigger mechanism engages. The lever is released from the spring pressure and remains in this position.

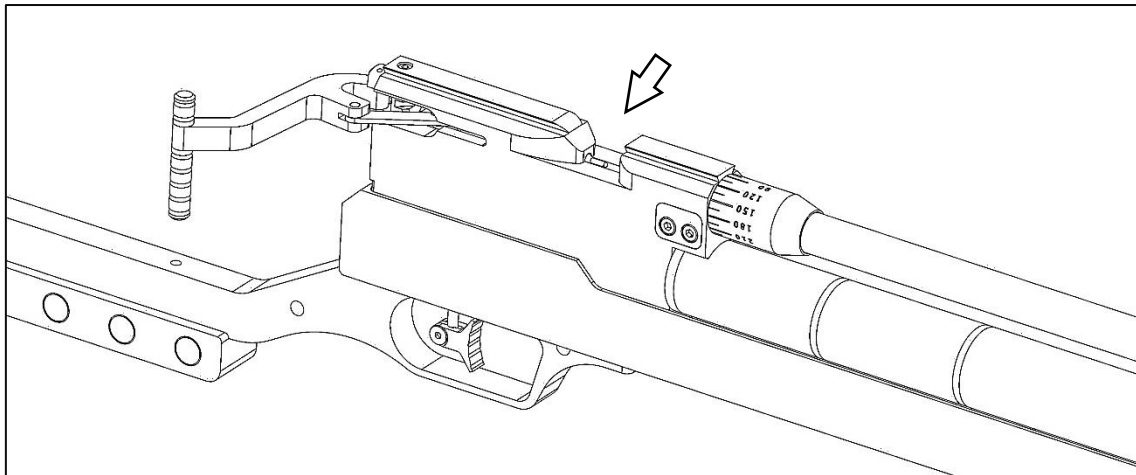

Lever open and needle retracted

You will see that the loading pin has been pulled back, so that you can now place the pellet on the groove in line with the barrel. By closing the lever and bringing it back to its initial position, the needle will insert the pellet into the muzzle of the barrel. At this point the carbine is loaded and armed, so we must exercise extreme caution and fire safely.

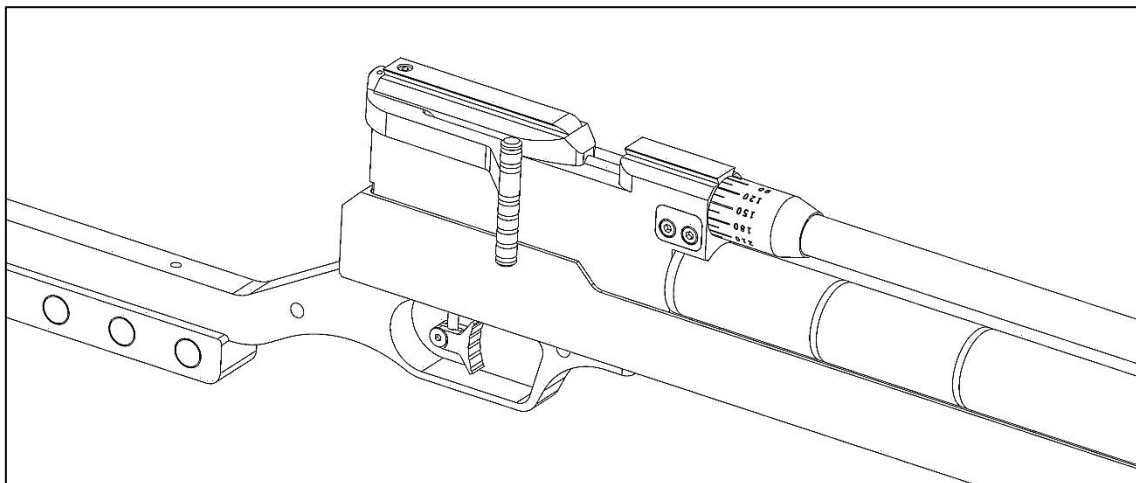

Closed lever



#### 4. BALLAST CONFIGURATION

The carbine has 2 mounts with different housings to place weights and to achieve the required weight according to the shooting modality.

The rear bracket incorporates 5 weights of 23gr. and the front bracket 4 weights of 73gr.

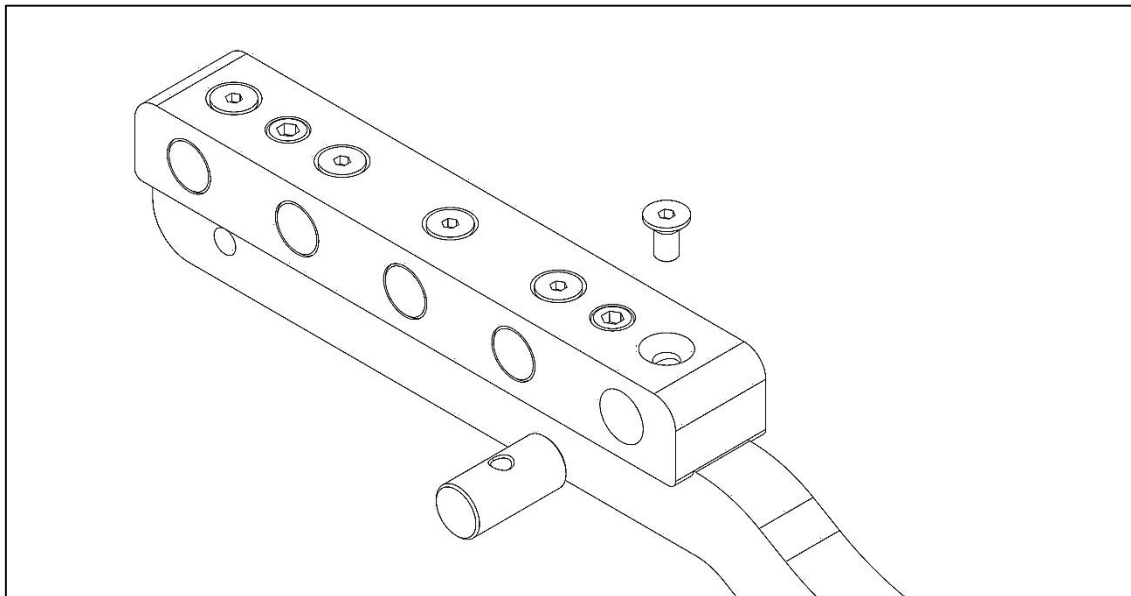

Rear bracket

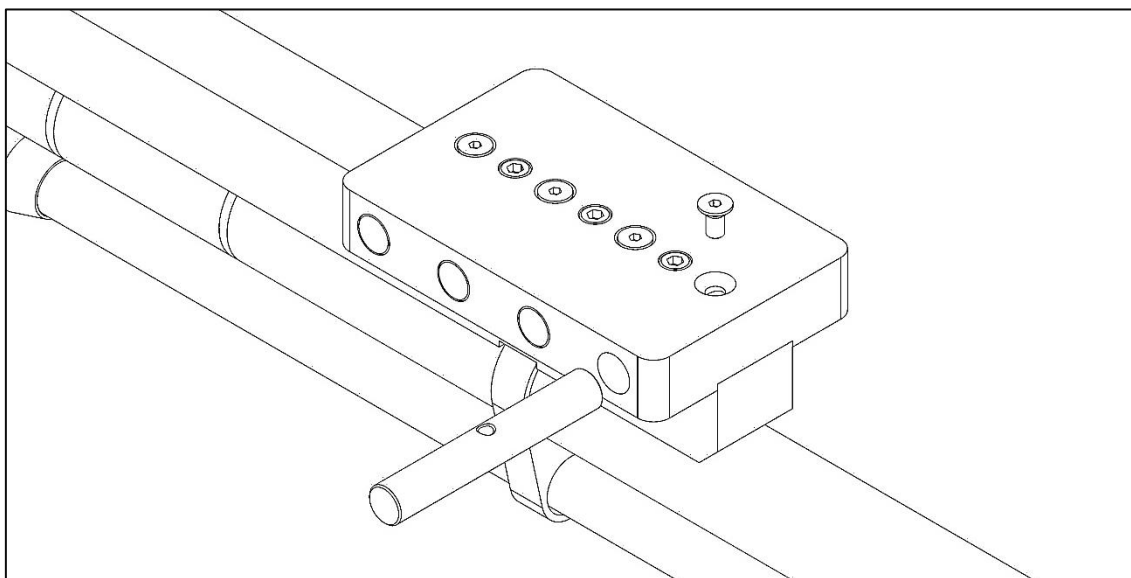

Front bracket

## Instruction manual XR-100 Carbine



The XR-100 carbine is produced in 2 variants, Varmint light and Varmint heavy. The difference in weight between the two is due to the design and materials of the pistol grip and rear ballast holder.

For the lightweight Varmint we have a pistol grip and bracket made of anodized aluminum with a total weight (including weights) of 485gr.

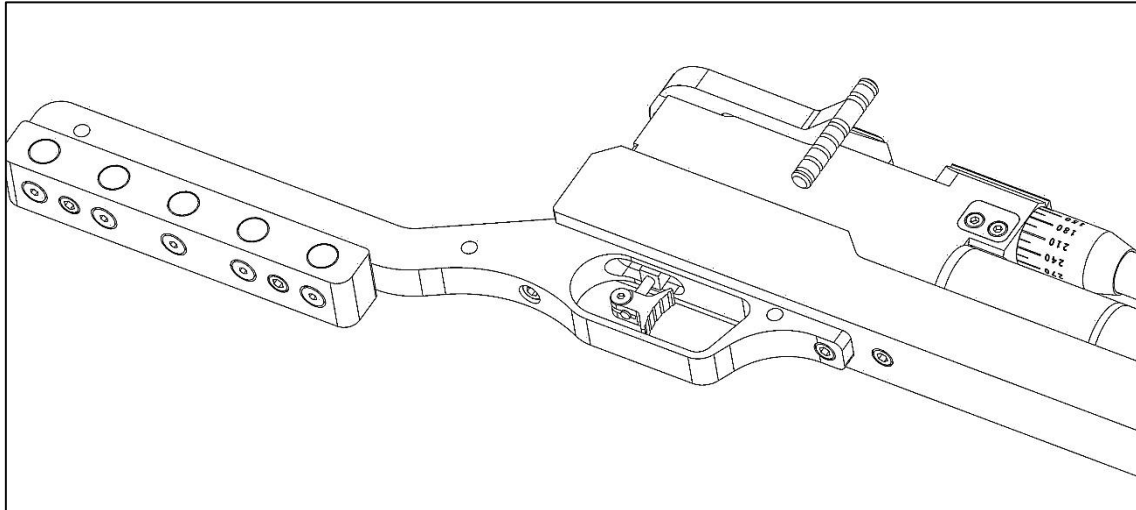

Light Varmint

For the heavy Varmint we have a pistol grip and bracket made of blued steel with a total weight (including weights) of 1825gr.

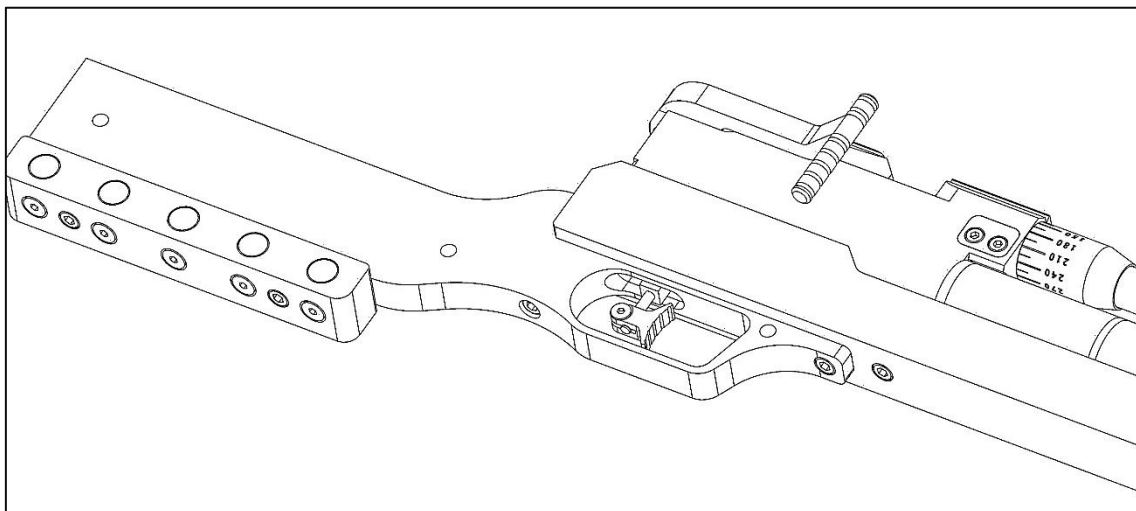

Heavy Varmint

## 5. REMOVE THE CYLINDER HEAD

If we need to carry out any maintenance operations or change the settings, it may be necessary to remove the cylinder head. In order to remove it, we start by removing the front support for supplements by removing the 3 screws that fix it to the stock. Next, the screws that attach the stock to the carbine are removed. The first screw is located next to the trigger guard and the second one under the eigh.

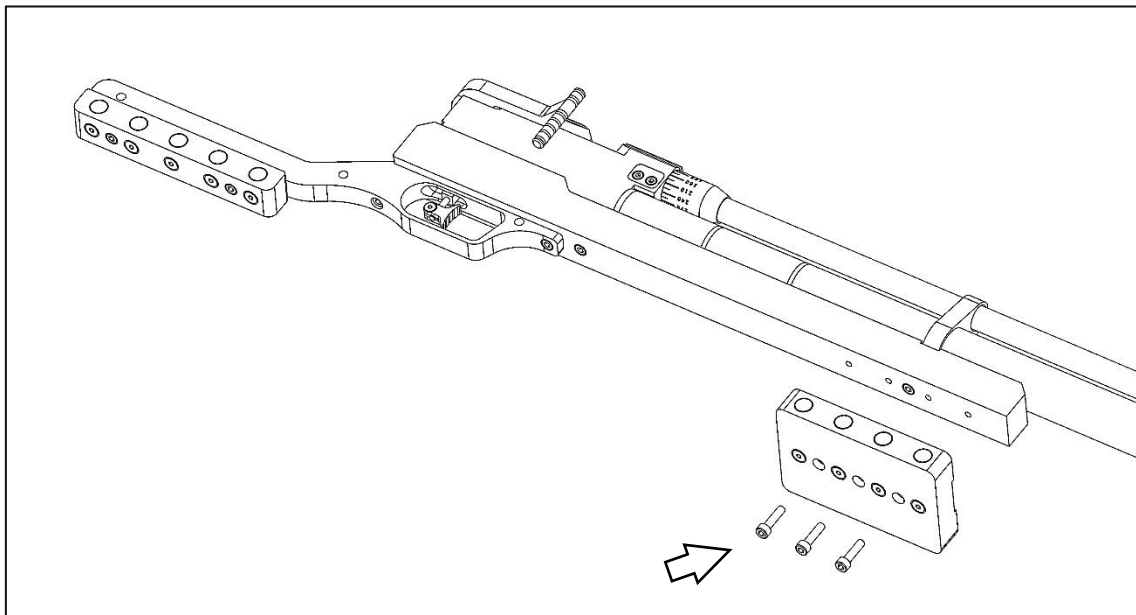

Removing the front ballast support

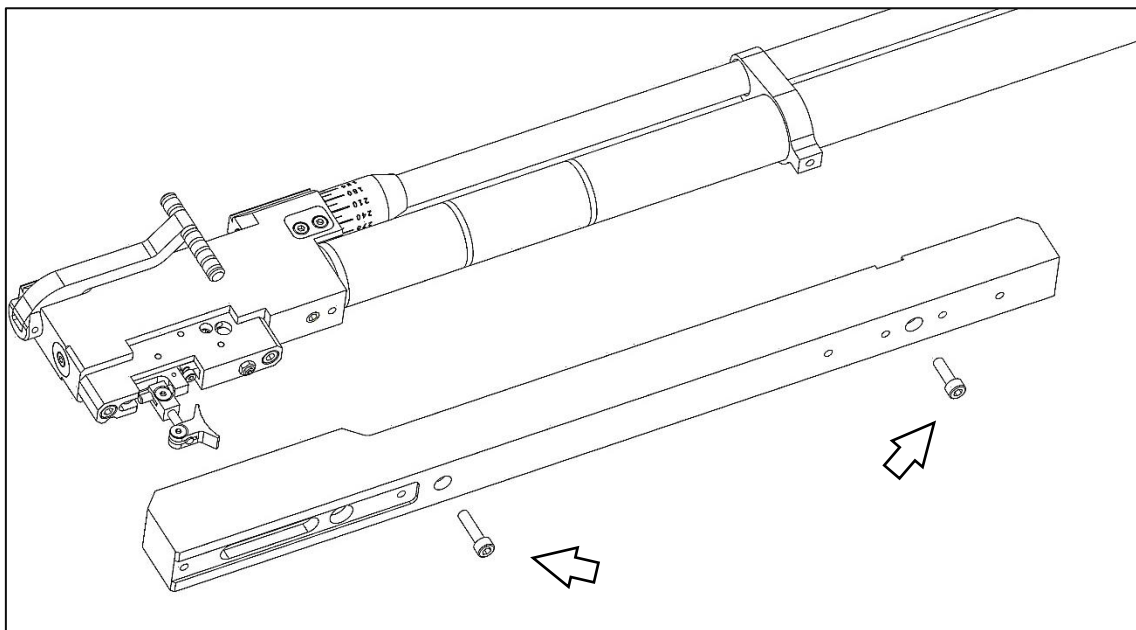

Head mounting bolts

## 6. ADJUST THE POWER

To adjust the power of the LOBO AirGuns XR-100 carbine® it is not necessary to disassemble the stock as the adjustment screw is easily accessible and is located at the rear of the carbine body.

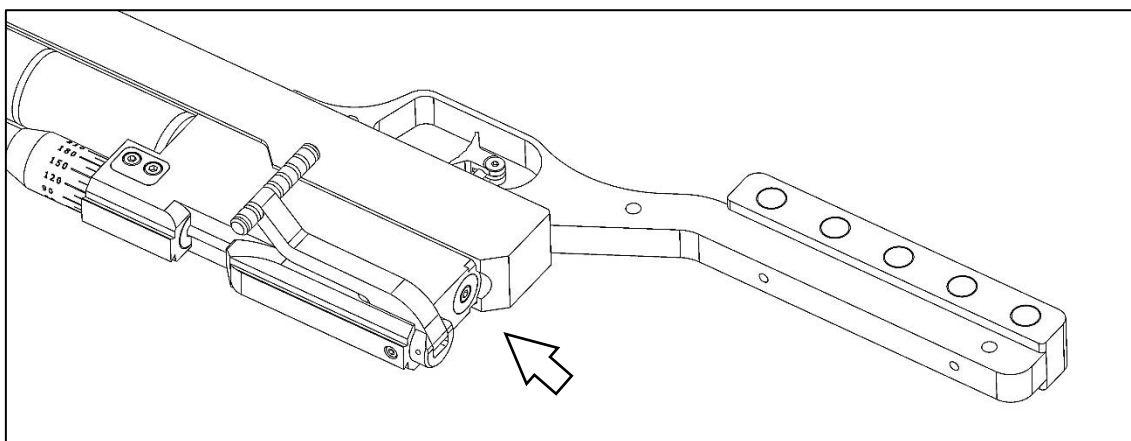

Power adjustment screw

By tightening this screw we will also be compressing the internal spring and thus increasing the firing force. To check or replace the loading spring, we will have to turn the screw until the part screwed to the body of the carbine is completely removed.

If the bolt does not behave properly, is too hard or too light, it may be necessary to check the indicated bolt acting as a brake, so the cylinder head must first be removed.

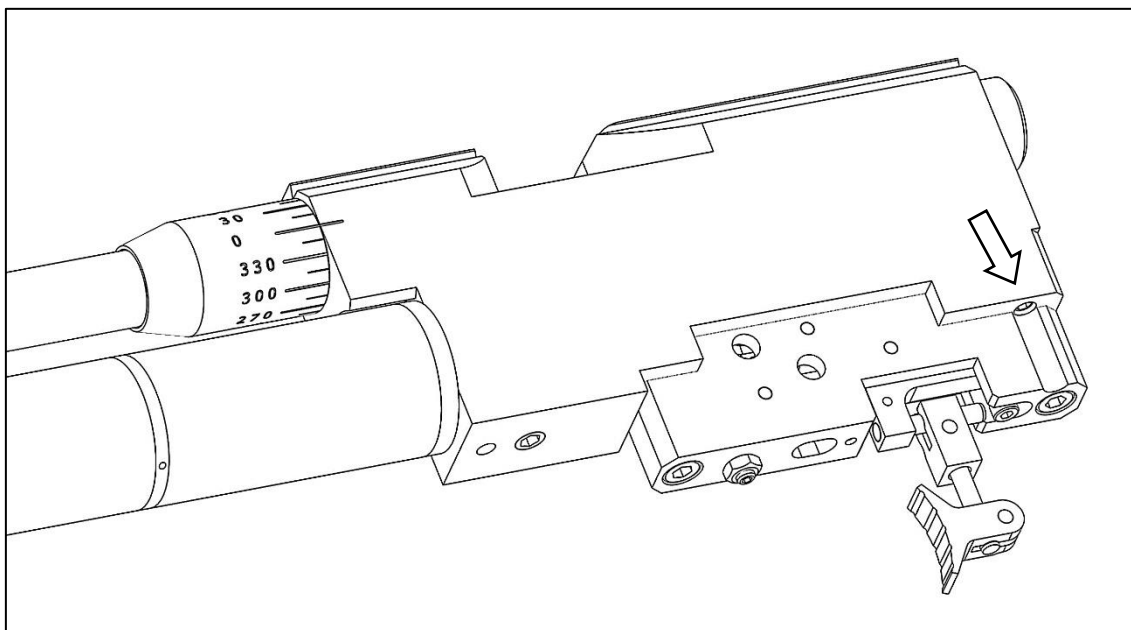

Power adjustment screw brake

## 7. AIR LOAD

The tank is filled at the end of the tank, just behind the pressure gauge. By turning the cap protecting the pressure gauge, the filling inlet is accessible. In case of wear or breakage, the O-rings (NBR Ø6 x 1.5) must be replaced.

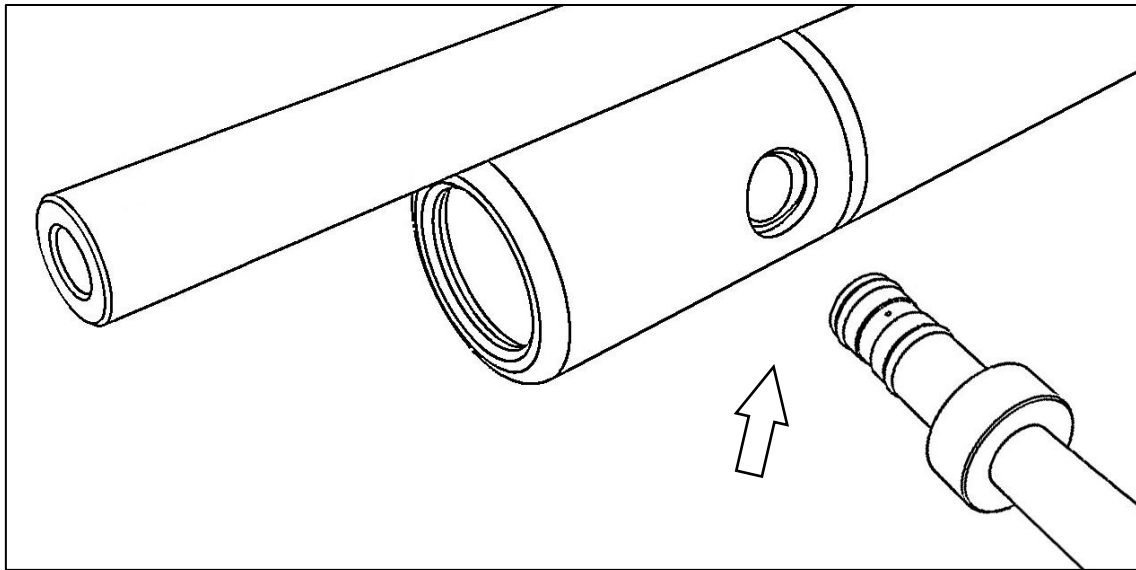

Air charging port

LOBO AirGuns® supplies a quick-connect nozzle for use with a filling hose.

### **IMPORTANT**

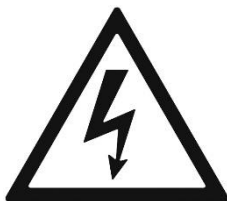

*IF CYLINDERS OR COMPRESSORS ARE USED TO FILL THE TANK, THIS MUST BE DONE IN A SLOW AND GRADUAL MANNER TO AVOID SUDDEN STRESSES ON THE INTERNAL COMPONENTS.*

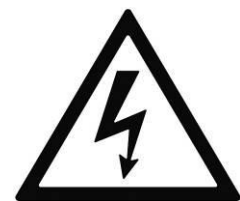

The tank must be emptied for any maintenance or replacement of one or more components. For this purpose, we have provided a screw which must be opened very slowly to let the air out of the tank. It is sufficient to turn the screw anticlockwise by half a turn, or a maximum of one turn, for the tank to start emptying.

To access this screw, remove the cap protecting the pressure gauge and use a 2mm Allen key.

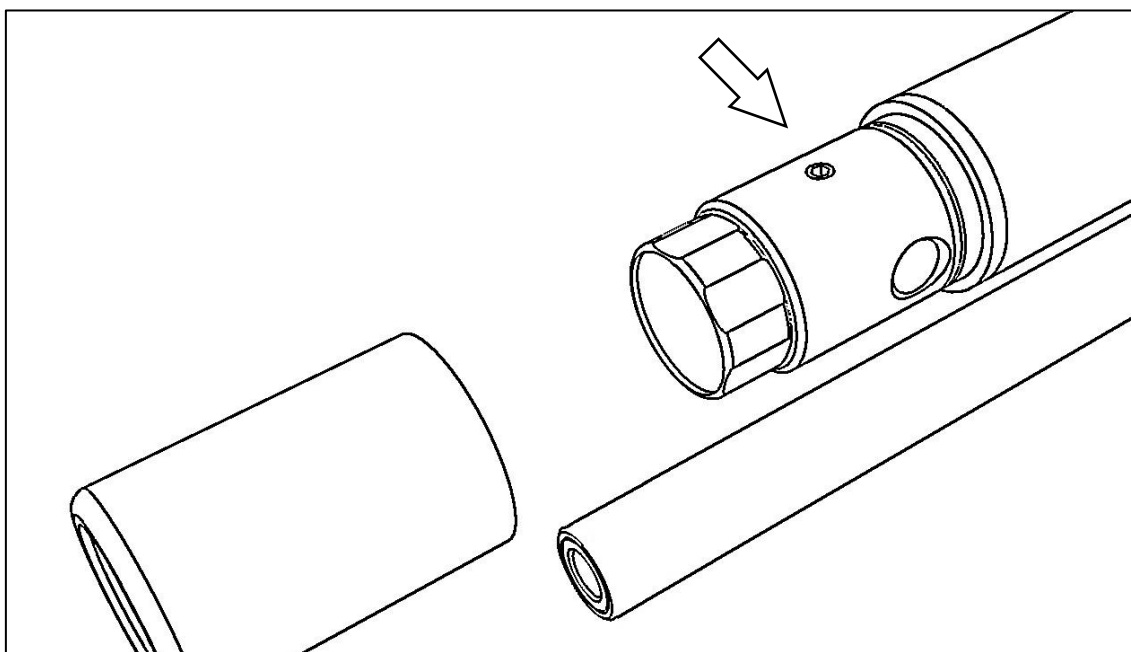

Tank drain screw

## 8. ROTATING THE CANNON

Each shot produces different harmonic vibrations in the barrel, which directly influences the groupings. If the barrel is rotated, the oscillations move along the barrel, so we can synchronise the midpoint of the wave with the exit of the pellet.

In addition to the construction of the barrel itself, harmonics will vary depending on the ammunition used, power output, etc. So a setting optimized for a given ammunition and carbine configuration will not adjust to a change in any of these.

In order to rotate the barrel of the XR-100 carbine, just loosen the 2 screws in the picture slightly with a 3mm Allen key.

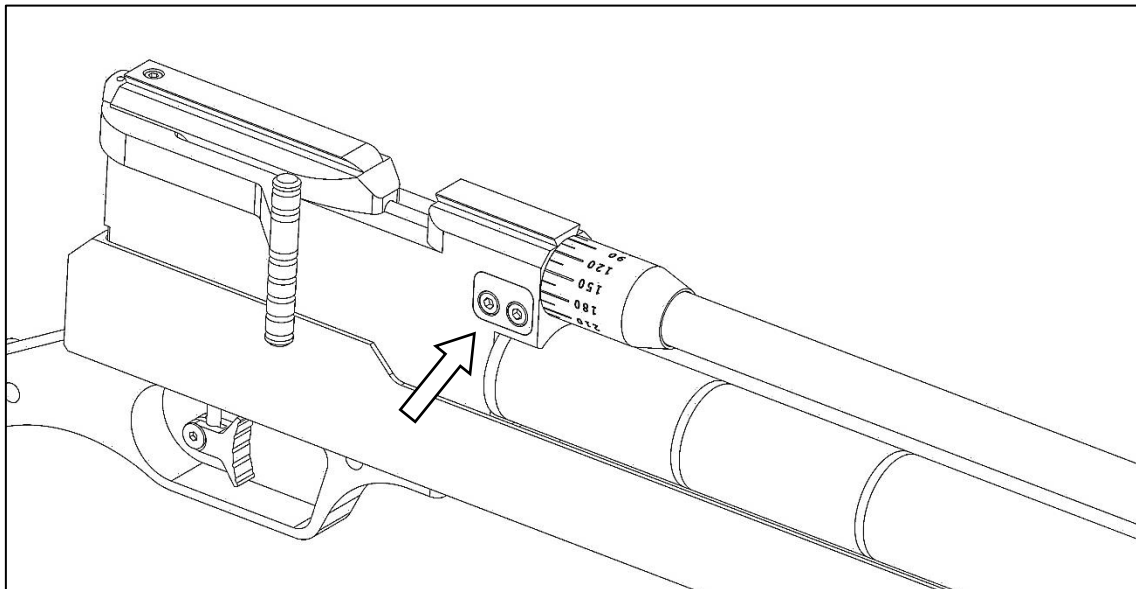

Barrel rotation

If it is necessary to remove the barrel for replacement, cleaning or checking, simply loosen the above mentioned screws sufficiently to be able to pull the barrel out.

All guns supplied by LOBO AirGuns® are manufactured to the highest standards of quality and precision.

## 9. REMOVING THE TANK

### **IMPORTANT**

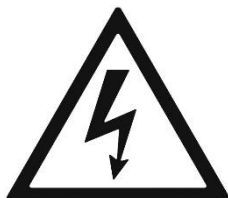

*IT IS ABSOLUTELY ESSENTIAL THAT THE TANK IS COMPLETELY EMPTY BEFORE REMOVING IT FROM THE CARBINE.*

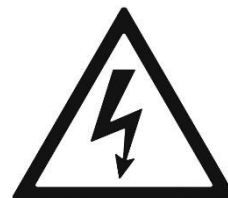

In order to remove the tank, the cylinder head must be previously disassembled (see point N°5 of this manual). We only have to remove the screw indicated in the image with a 4mm Allen key and we extract the tank outwards.

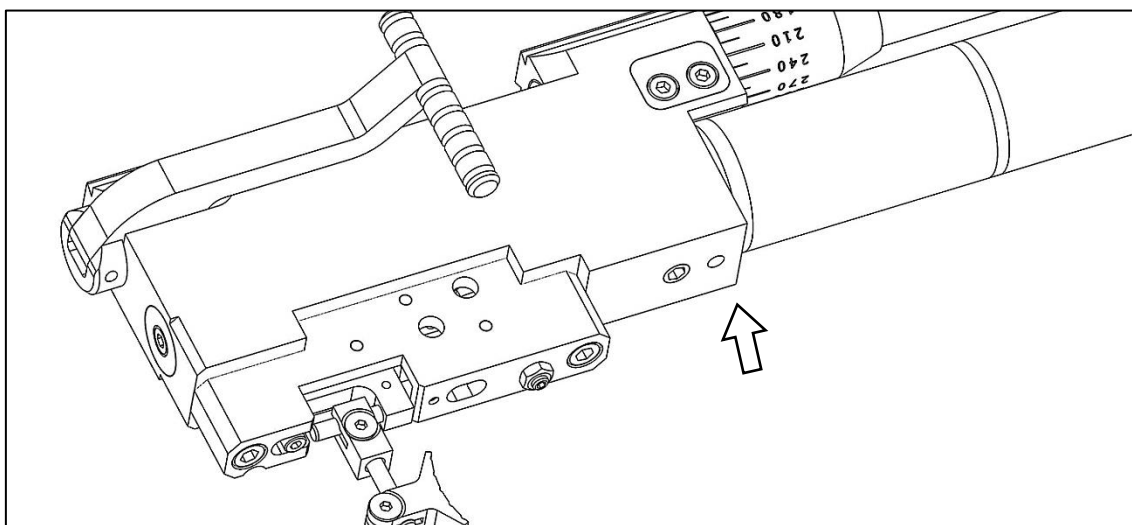

Removal of the tank



## 10. ADJUST THE TRIGGER

The trigger has 5 adjustment points accessible after removal of the stock (see point 5 for instructions on how to remove the stock).

1. Maximum trigger travel (Allen key 2,5mm.)
2. Triggering time (Allen key 1.5mm.)
3. Trigger linkage travel (2mm Allen key + 7mm open end spanner)
4. Trigger tilt and position adjustment (Allen key 2,5mm.)
5. Trigger rotation and height adjustment (Allen key 2,5mm.)

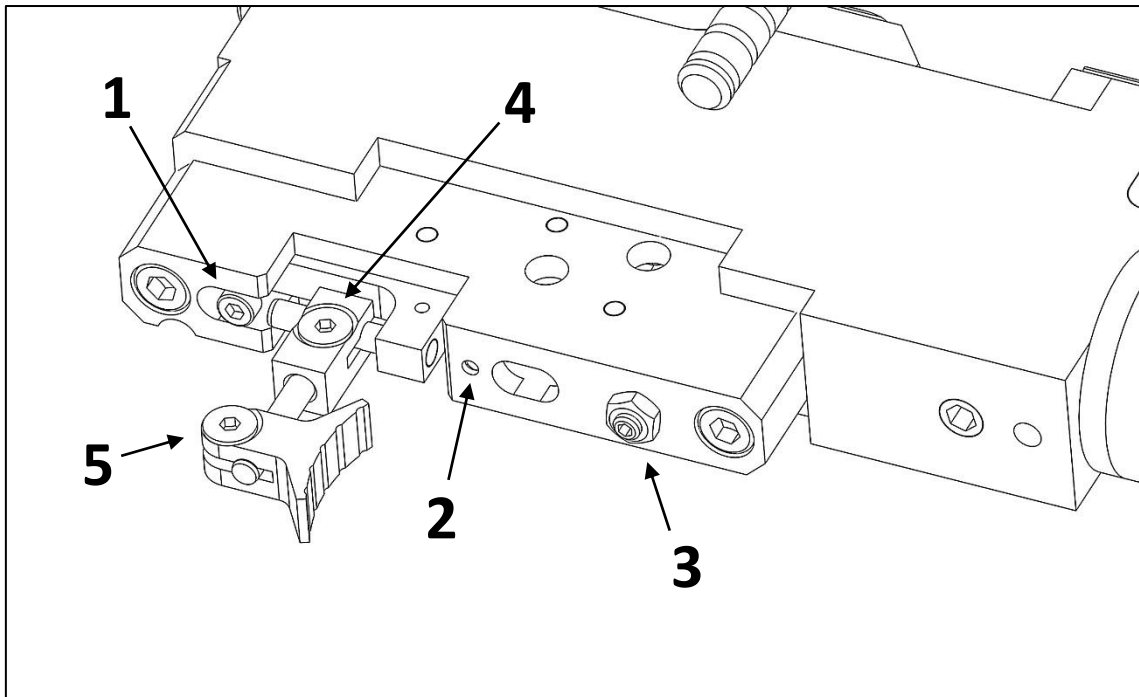

### **IMPORTANT**

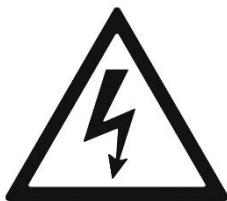

*LOBO AIRGUNS DELIVERS THE CARBINE ADJUSTED. INCORRECT MODIFICATION OF THESE SETTINGS MAY RESULT IN UNINTENTIONAL FIRING OF THE CARBINE.*

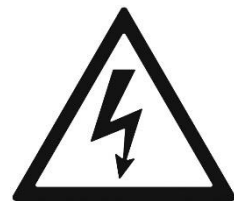

## 11. SPECIFICATIONS

MODEL	XR-100
CALIBRE	0.17" (4.5mm. )
BARREL LENGTH	550MM.
POWER	24J (ACCORDING TO SPANISH LAW)
TANK VOLUME	200 cc
MAXIMUM FILLING PRESSURE	250 bar
PRESSURE REGULATOR	DOUBLE BUILT-IN
CATCHER	TWO-STROKE, ADJUSTABLE
CULATA	ALUMINIUM / STEEL
DIMENSIONS	873 x 152 x 76,25
WEIGHT	VARMINT LIGHT = 3,7 - 4,3Kg. VARMINT HEAVY = 5,1 - 5,5Kg.
RAIL FOR MOUNT	11mm.

## **12. DIAGRAMS AND EXPLODED VIEWS**

### **12.1. CARABIN ASSEMBLY**

### **12.2. TRIGGER ASSEMBLY**



**THE CONTENTS OF THIS MANUAL, ASSEMBLY DRAWINGS,  
EXPLODED VIEWS AND ADJUSTMENTS ARE AVAILABLE FOR DOWNLOAD  
IN THE SUPPORT SECTION OF OUR WEBSITE**

**<https://www.loboairguns.com>**

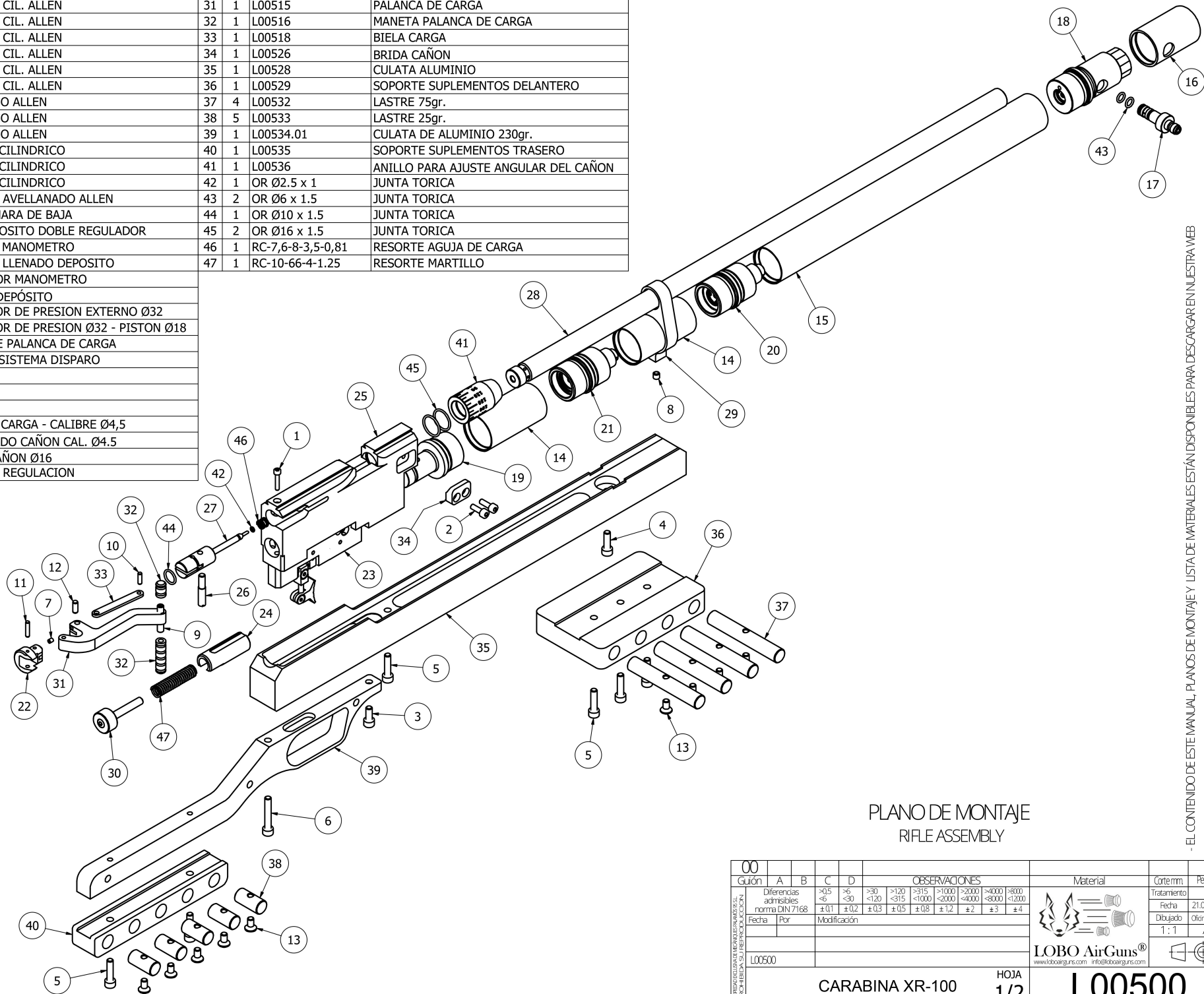
Nº	UDS.	PIEZA	DESCRIPCION	Nº	UDS.	PIEZA	DESCRIPCION
1	1	DIN 912 - M3 x 16	TORNILLO CIL. ALLEN	31	1	L00515	PALANCA DE CARGA
2	2	DIN 912 - M4 x 12	TORNILLO CIL. ALLEN	32	1	L00516	MANETA PALANCA DE CARGA
3	1	DIN 912 - M5 x 12	TORNILLO CIL. ALLEN	33	1	L00518	BIELA CARGA
4	1	DIN 912 - M5 x 16	TORNILLO CIL. ALLEN	34	1	L00526	BRIDA CAÑON
5	8	DIN 912 - M5 x 20	TORNILLO CIL. ALLEN	35	1	L00528	CULATA ALUMINIO
6	1	DIN 912 - M5 x 30	TORNILLO CIL. ALLEN	36	1	L00529	SOPORTE SUPLEMENTOS DELANTERO
7	1	DIN 913 - M3 x 4	ESPARRAGO ALLEN	37	4	L00532	LASTRE 75gr.
8	1	DIN 913 - M5 x 5	ESPARRAGO ALLEN	38	5	L00533	LASTRE 25gr.
9	1	DIN 913 - M5 x 25	ESPARRAGO ALLEN	39	1	L00534.01	CULATA DE ALUMINIO 230gr.
10	1	DIN 6325 - 3 x 10	PASADOR CILINDRICO	40	1	L00535	SOPORTE SUPLEMENTOS TRASERO
11	4	DIN 6325 - 3 x 14	PASADOR CILINDRICO	41	1	L00536	ANILLO PARA AJUSTE ANGULAR DEL CAÑON
12	1	DIN 6325 - 4 x 10	PASADOR CILINDRICO	42	1	OR Ø2.5 x 1	JUNTA TORICA
13	9	DIN 7991 - M5 x 10	TORNILLO AVELLANADO ALLEN	43	2	OR Ø6 x 1.5	JUNTA TORICA
14	2	L00003.05	TUBO CAMARA DE BAJA	44	1	OR Ø10 x 1.5	JUNTA TORICA
15	1	L00003.09	TUBO DEPOSITO DOBLE REGULADOR	45	2	OR Ø16 x 1.5	JUNTA TORICA
16	1	L00004	CUBIERTA MANOMETRO	46	1	RC-7,6-8-3,5-0,81	RESORTE AGUJA DE CARGA
17	1	L00005	BOQUILLA LLENADO DEPOSITO	47	1	RC-10-66-4-1.25	RESORTE MARTILLO
18	1	L00006	ADAPTADOR MANOMETRO				
19	1	L00012.01	VÁLVULA DEPÓSITO				
20	1	L00018.03	REGULADOR DE PRESION EXTERNO Ø32				
21	1	L00018.05	REGULADOR DE PRESION Ø32 - PISTON Ø18				
22	1	L00061.01	BULON EJE PALANCA DE CARGA				
23	1	L00504	SOPORTE SISTEMA DISPARO				
24	1	L00505	MARTILLO				
25	1	L00506	CUERPO				
26	1	L00508	PASADOR				
27	1	L00509	AGUJA DE CARGA - CALIBRE Ø4,5				
28	1	L00511	MECANIZADO CAÑON CAL. Ø4.5				
29	1	L00512	OCHO - CAÑON Ø16				
30	1	L00514	TORNILLO REGULACION				



PLANO DE MONTAJE  
RIFLE ASSEMBLY

00																	
Guión	A	B	C	D	OBSERVACIONES								Material		Corte mm	Peso kg.	
PROHIBIDA SU REPRODUCCION TOLERANCIAS EN MEDIDAS Y MASAS: PROHIBIDA SU REPRODUCCION	Diferencias admisibles norma DIN 7168		>0.5 <6	>6 <30	>30 <120	>120 <315	>315 <1000	>1000 <2000	>2000 <4000	>4000 <8000	>8000 <12000			Tratamiento		21.02.2022	
	Fecha	Por	Modificación										Dibujado		Oficina técnica		
													1 : 1		A2		
L00500												LOBO AirGuns® www.loboguns.com info@loboguns.com					
CARABINA XR-100					HOJA 1/2		L00500										

- EL CONTENIDO DE ESTE MANUAL, PLANOS DE MONTAJE Y LISTA DE MATERIALES ESTÁN DISPONIBLES PARA DESCARGAR EN NUESTRA WEB  
- THE CONTENT OF THIS MANUAL, ASSEMBLY PLANS AND PARTS LISTS ARE ALSO AVAILABLE FOR DOWNLOAD FROM OUR WEBSITE

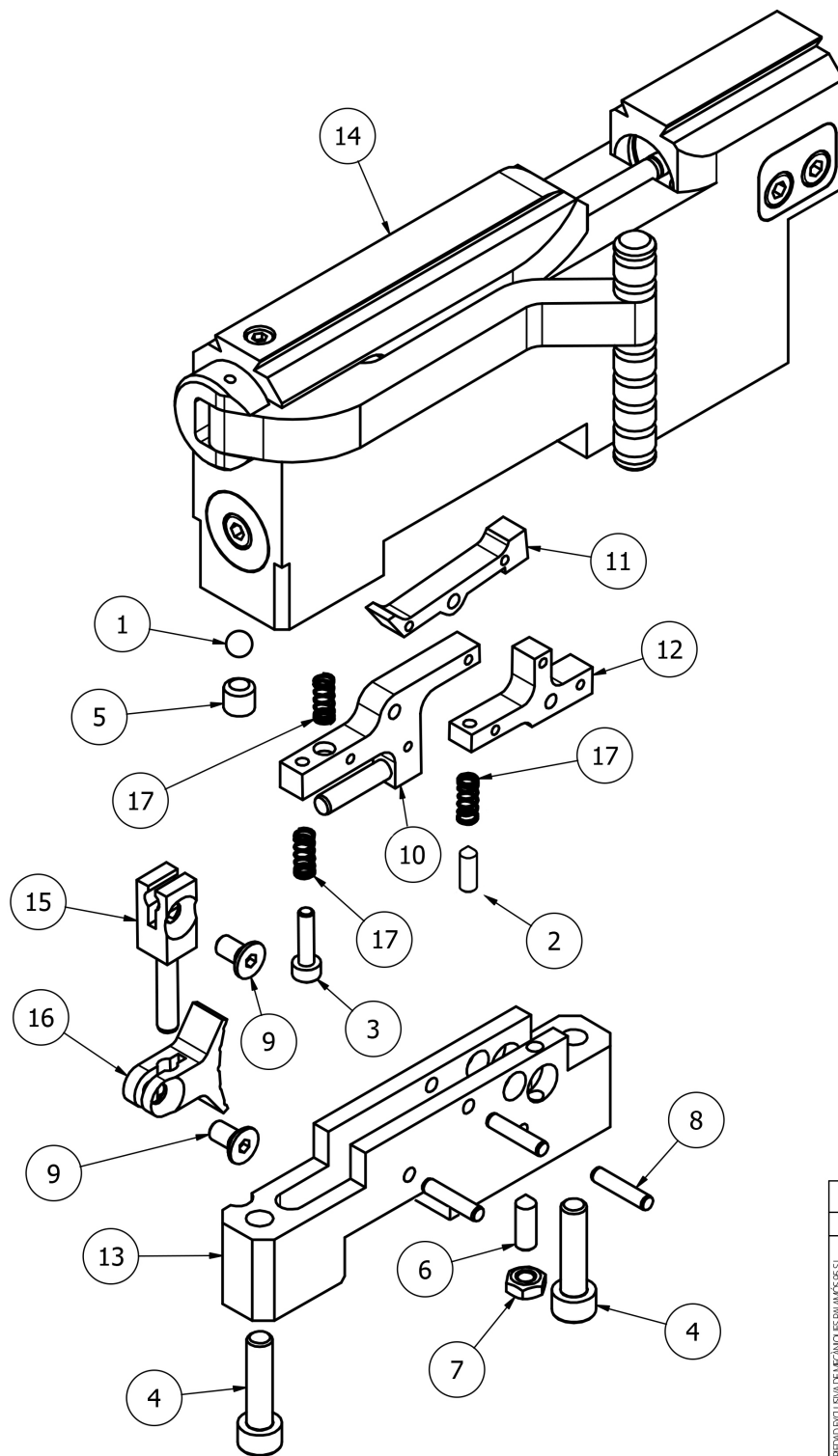

Nº	UDS.	PIEZA	DESCRIPCIÓN
1	1	BOLA DELRIN Ø5	
2	1	DIN 913 - M3 x 8	TORNILLO CILINDRICO ALLEN
3	1	DIN 912 - M3 x 12	TORNILLO CILINDRICO ALLEN
4	8	DIN 912 - M5 x 20	TORNILLO CILINDRICO ALLEN
5	1	DIN 913 - M6 x 6	ESPARRAGO ROSCADO
6	1	DIN 914 - M4 x 12	ESPARRAGO ROSCADO
7	1	DIN 934 - M4	TUERCA HEXAGONAL
8	4	DIN 6325 3 x 14	PASADOR CILINDRICO
9	2	DIN 7991 - M4 x 8	TORNILLO AVELLANADO ALLEN
10	1	L00501	SOPORTE GATILLO
11	1	L00502	DISPARADOR
12	1	L00503	ENLACE
13	1	L00504	SOPORTE SISTEMA DISPARO
14	1	L00506	CUERPO
15	1	L00524	BRAZO GATILLO
16	1	L00525	GATILLO
17	3	RC-4-9-1.5-0.4	RESORTE A COMPRESION

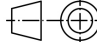
00																
Guión		A	B	C	D	OBSERVACIONES						Material		Corte mm	Peso kg.	
PROPIEDAD EXCLUSIVA DE MECANICAS PAMONOS S.L. PROHIBIDA SU REPRODUCCION	Diferencias admisibles norma DIN 7168			>0.5 <-6	>6 <-30	>30 <-120	>120 <-315	>315 <-1000	>1000 <-2000	>2000 <-4000	>4000 <-8000	>8000 <-12000			Tratamiento	
				±0.1	±0.2	±0.3	±0.5	±0.8	±1.2	±2.0	±3	±4			Fecha	21.02.2022
	Fecha	Por	Modificación										Dibujado		Oficina técnica	
													1 : 1		A3	
	L00500															
	CARABINA XR-100															
												HOJA		L00500		
												2/2				